

DW Series Overview

Battery Connectors for Power Storage

January 2014

Connector Line-up for Power Storage



Technology to Inspire Innovation

DW1

Large-scale power storage battery (>25kWh)
Plant, Building, etc

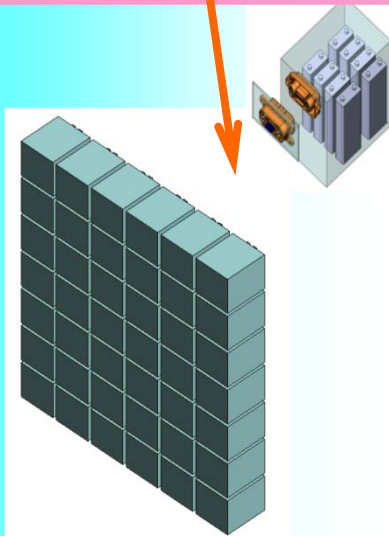

DW2

Mid-range power storage battery (10-25kWh)
Industrial, Office, etc

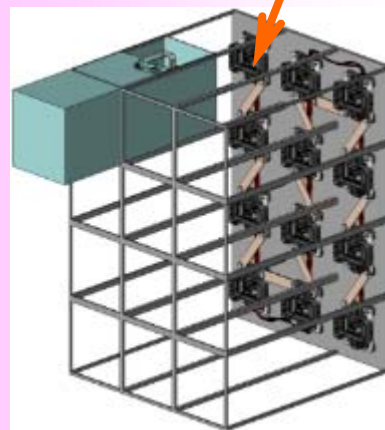
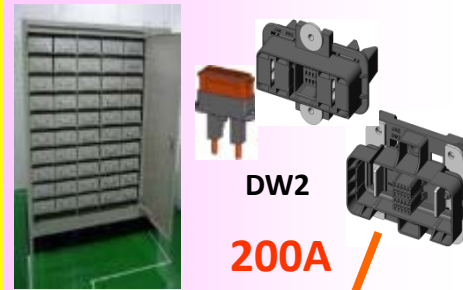

DW3

Rechargeable battery (<10kWh)
Residential, Commercial, etc



For 1U rack size

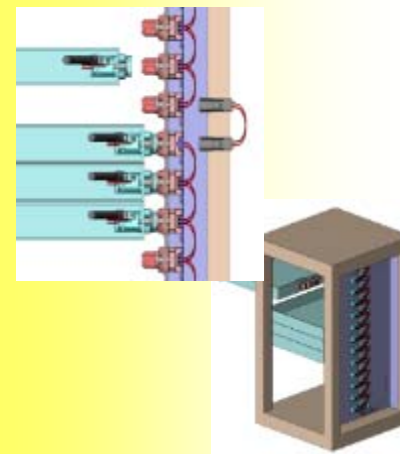

DW4

Commercial facility (<10kWh)
Convenience store, etc

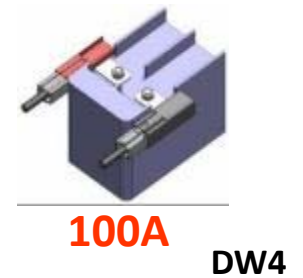

Integrated Signal and Power Connectors



Technology to Inspire Innovation

Easy to harness

DW1

Receptacle
On Battery



Plug
On Panel

Power

DW2

Receptacle
On Battery

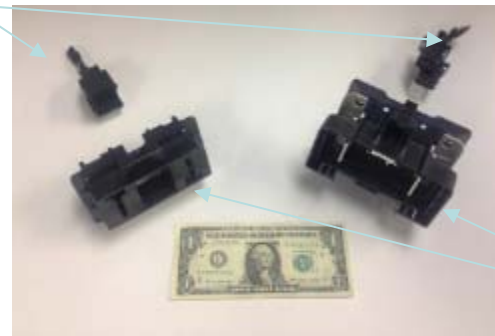

Plug
On Panel

Power

DW3

Receptacle
On Battery



Plug
On Panel

Power

DW1, 2, 3 Series Overview



Technology to Inspire Innovation

| | | DW1 | DW2 | DW3 |
|--------------------------|------------|------------|------------|-----------|
| Power Contact Current | | 500A | 200A | 150A |
| Floating Range | | +/- 2.75mm | +/- 2.75mm | +/- 2.0mm |
| Mounting Dimensions (mm) | Plug | 185 x 63 | 115.7 x 95 | 168 x 40 |
| | Receptacle | 190 x 72 | 115 x 84.6 | 156 x 28 |

Ideal for 1U racks

Features

- Power and signal contacts in one robust insulator
- Easy to harness signal contact unit
- High-reliability 2 points of contact (similar to automotive contacts)
- Electric shock prevention (DW1 plug, DW2 rec, DW3 plug and rec)
- Bus-bar or ring terminal harnessed cable to connect battery modules
- Mold and rubber flame retardant 94-V0

DW1 Specifications



Technology to Inspire Innovation

| | | |
|---------------------------------------|--------|--------------|
| Power pins | | 2 |
| Signal pins | | 20 |
| Rated current | Power | 500 A |
| | Signal | 2 A |
| Rated voltage | Power | 600 V |
| | Signal | 100 V |
| Overvoltage category | | 4 |
| Pollution grade | | 3 |
| Temperature increase at power portion | | 45 C |
| Ambient temperature | | -25 to +60 C |
| Allowable temp at power portion | | 105 C |

Receptacle



Plug

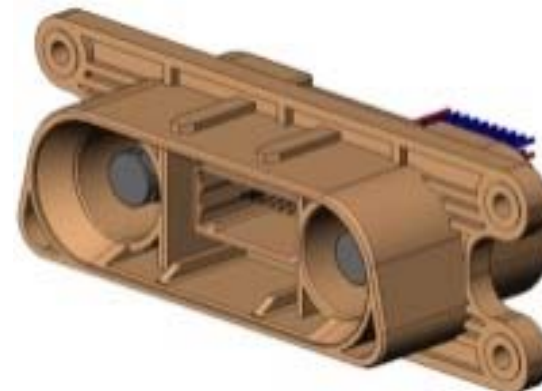

DW1 Application Example



Technology to Inspire Innovation

Large-scale Power Storage

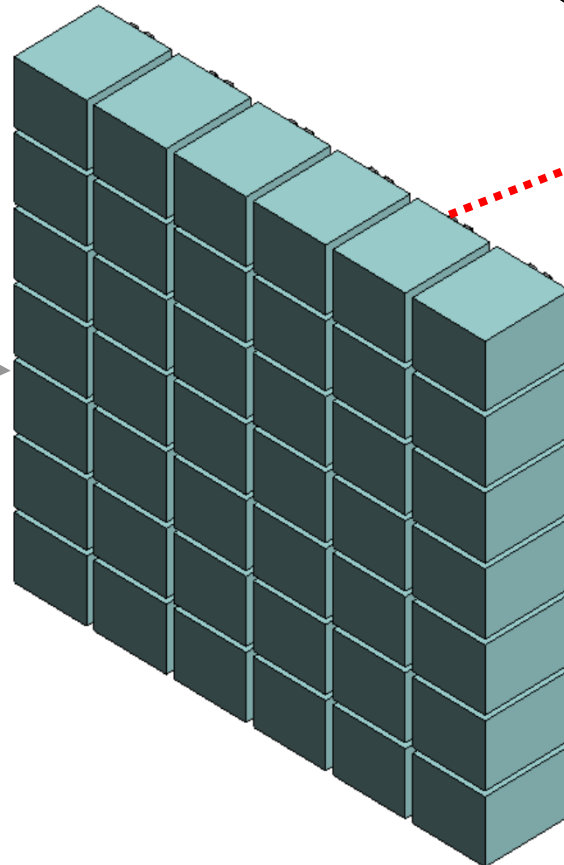

Rack and Panel

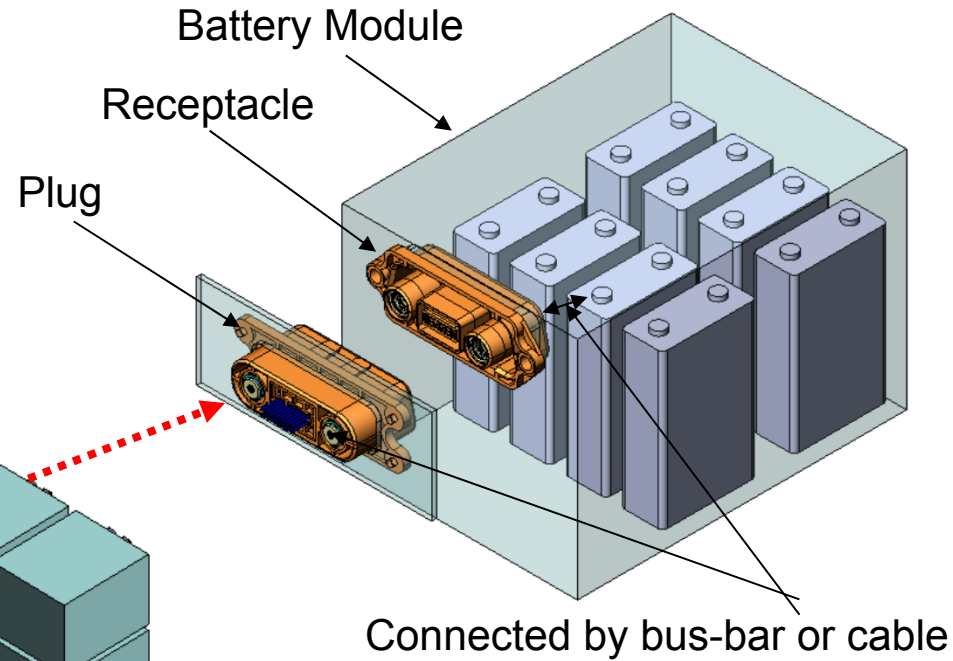

Battery Module mounting image

DW1 Electric Shock Prevention



Technology to Inspire Innovation

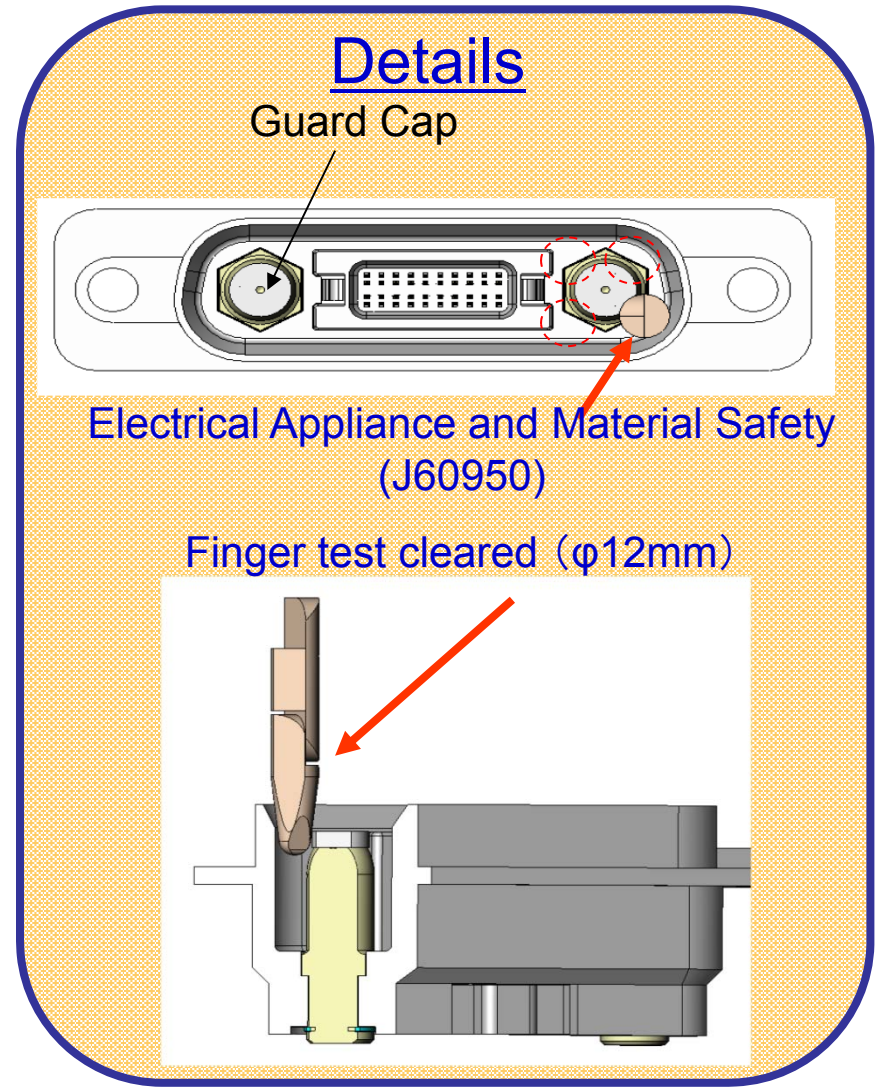
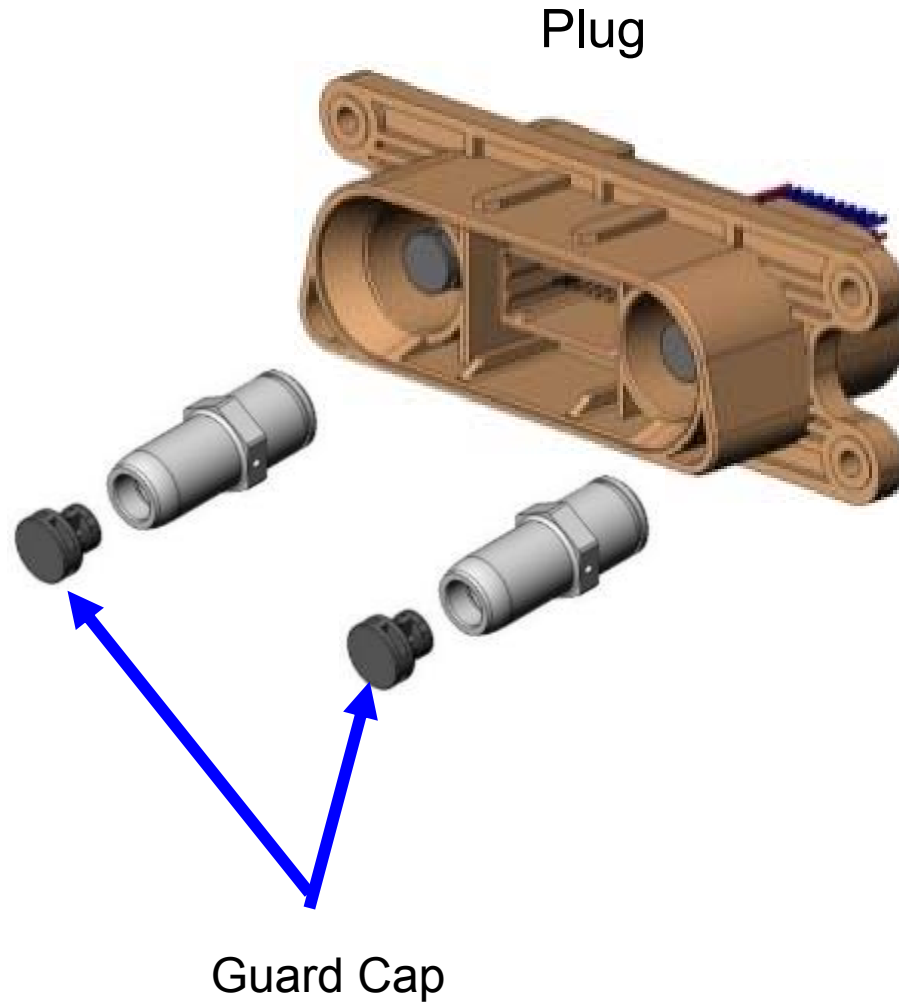

DW1 Connector Parts



Technology to Inspire Innovation

Receptacle

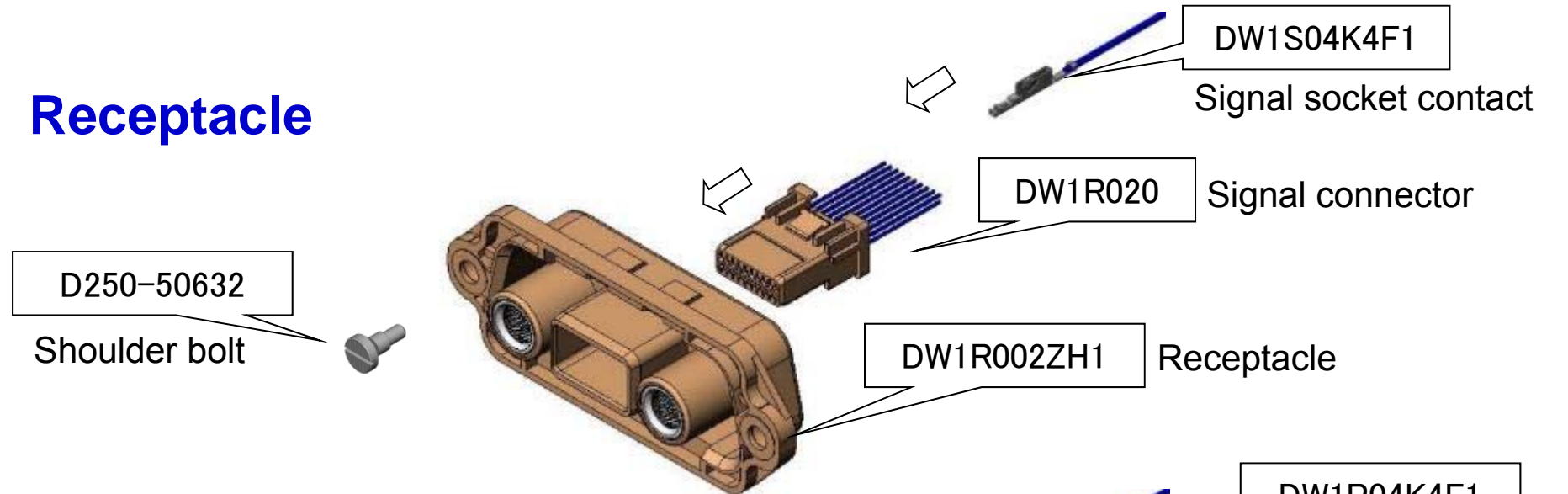

Plug

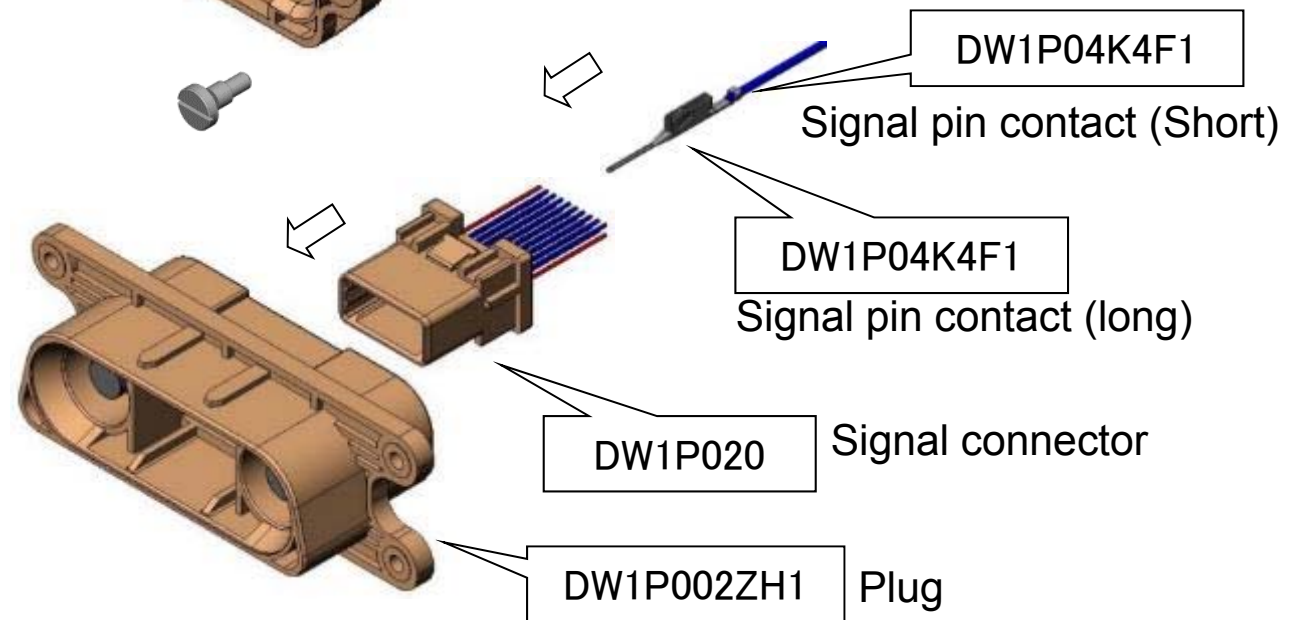

DW2 Specifications



Technology to Inspire Innovation

| | | |
|---|---------------|---------------------|
| Power pins | | 2 |
| Signal pins | | 20 |
| Rated current | Power | 200 A |
| | Signal | 2 A |
| Rated voltage | Power | 1000 V |
| | Signal | 100 V |
| Overvoltage category | | 4 |
| Pollution grade | | 3 |
| Temperature increase at power portion | | 45 C |
| Ambient temperature | | -25 to +60 C |
| Allowable temperature at power portion | | 105 C |

Movable side (battery side)

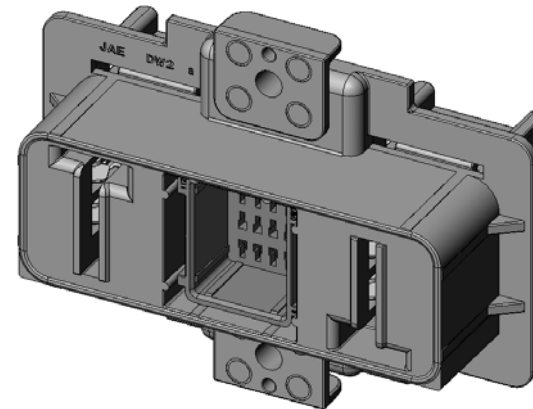

Fixed side (panel side)

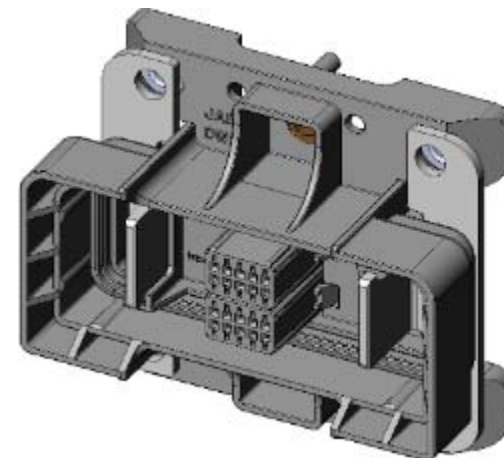

DW2 Application Example



Technology to Inspire Innovation

Mid-range Power Storage



Battery Module

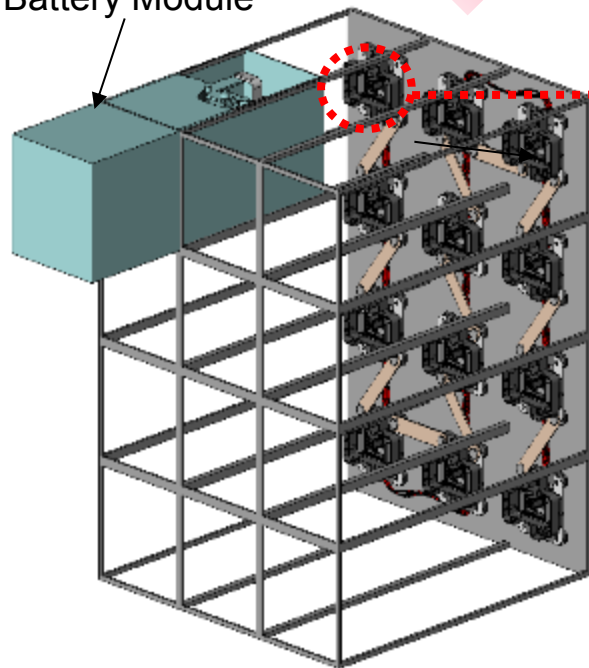

Rack and Panel

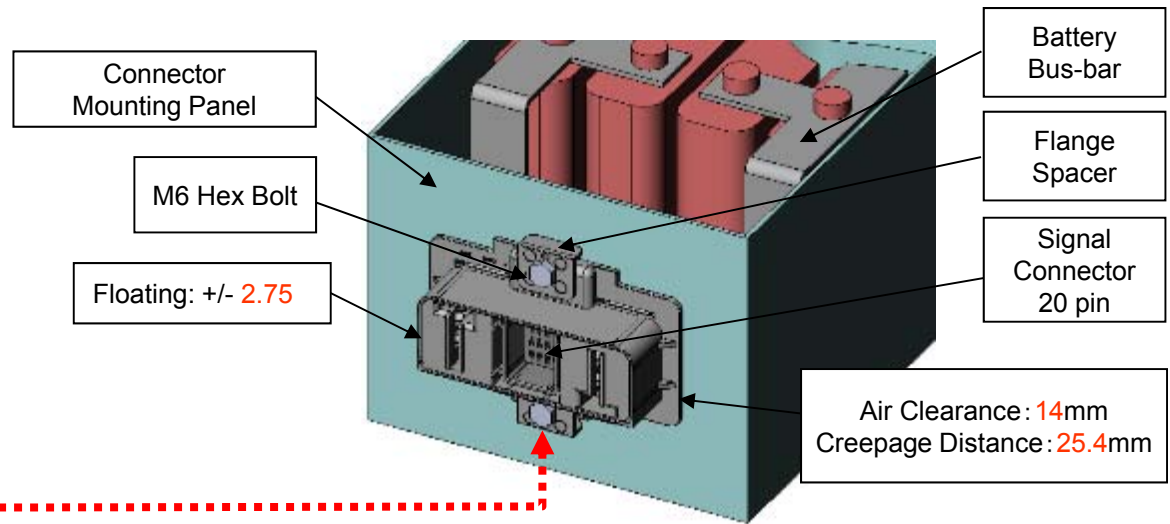

Battery Module Exterior

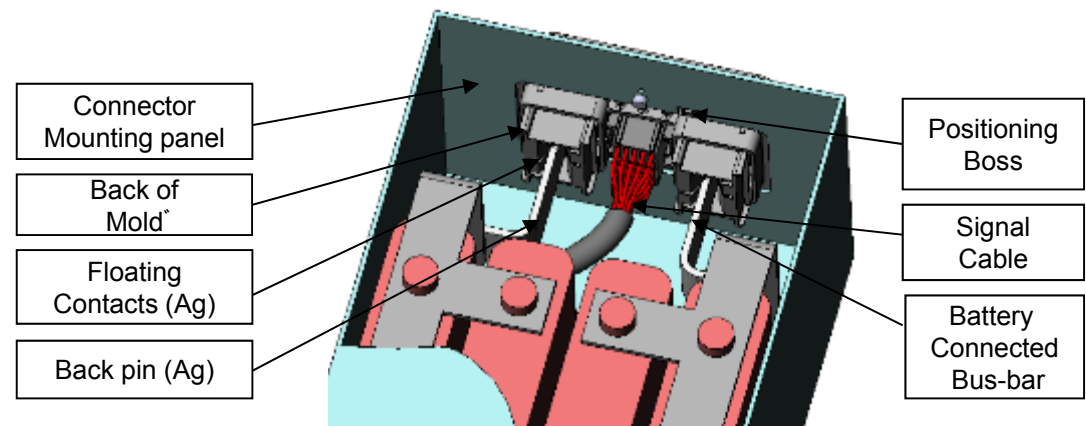

Battery Module Interior

DW2 Mounting Features

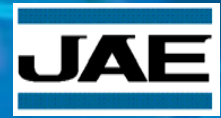

Technology to Inspire Innovation

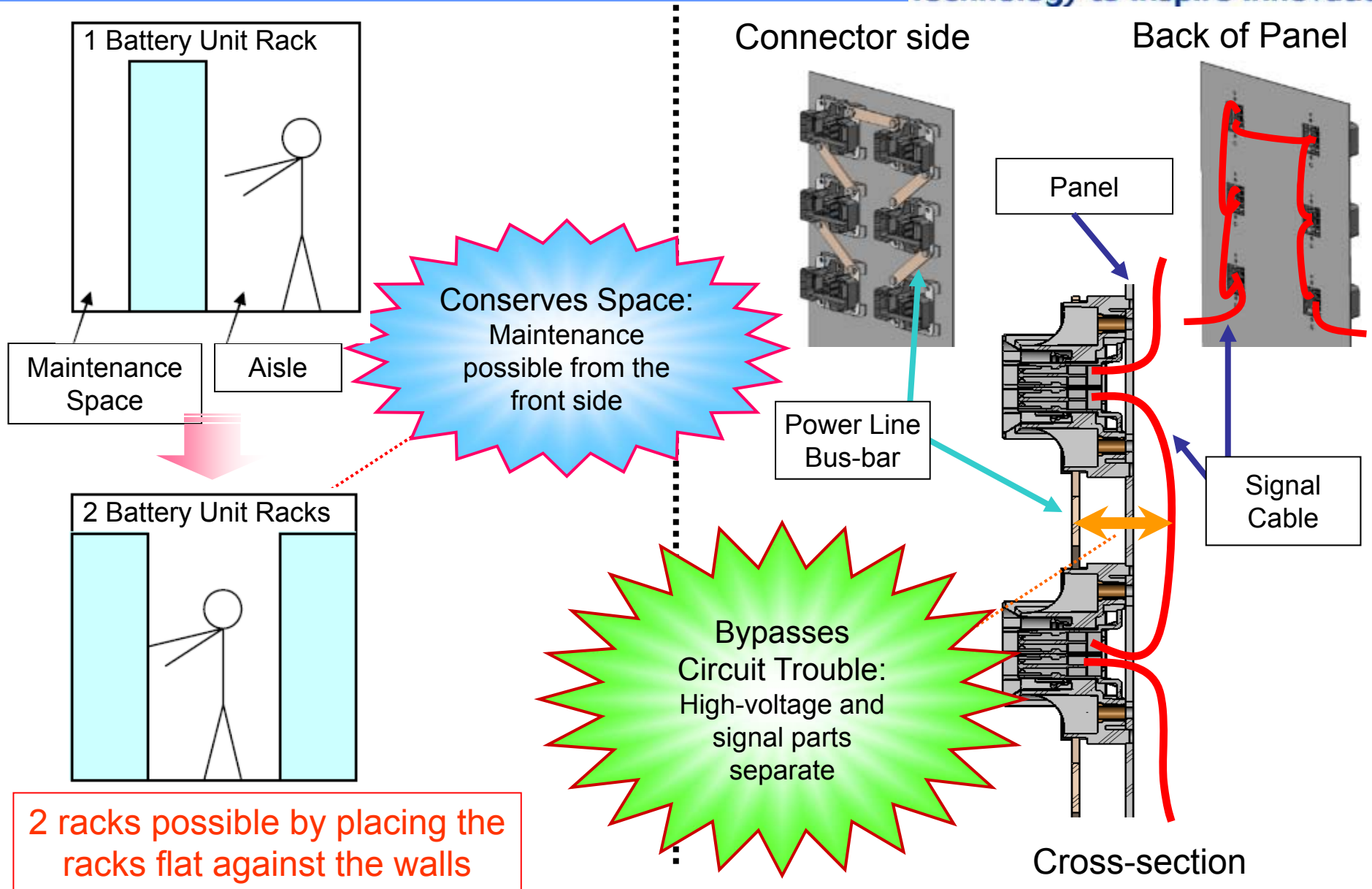

DW2 Connector Parts



Technology to Inspire Innovation

Receptacle

Plug

Contacts packaged in reels

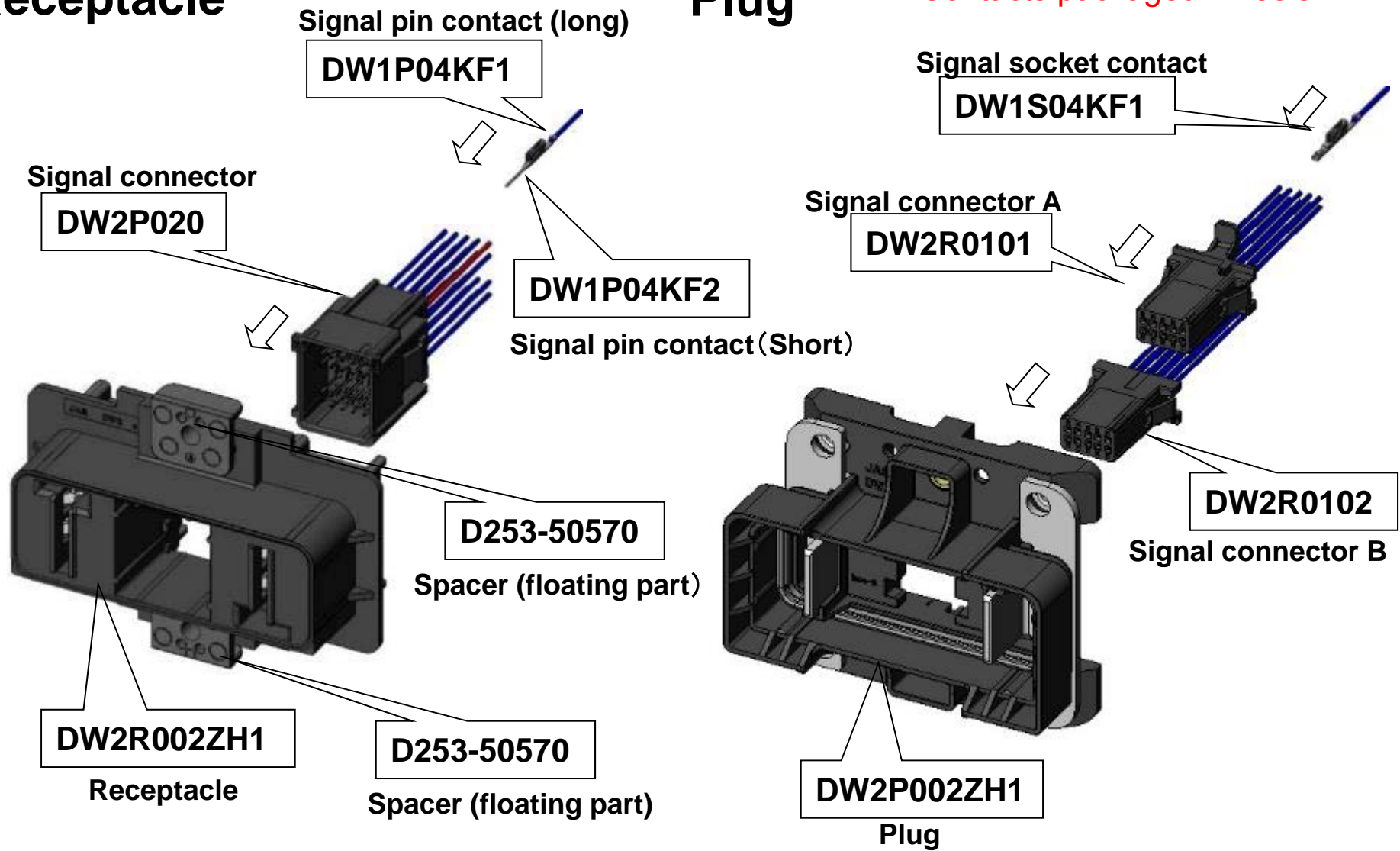

DW3 Specifications



Technology to Inspire Innovation

| Item | Power | Signal |
|--|---|--|
| Pin count | 2 pins | 24 pins |
| Rated current | 150 A | 2 A |
| Rated voltage | 1,000 V | 100 V |
| Contact resistance | Initial: Max. 0.2 | Initial: Max. 20 After evaluation: Max. 30 |
| Cable | Bus bar: Width 15 +/- 1mm Thickness 3 +/- 0.1mm | AWG22 (0.3mm ²) Outer diameter of coated cable: 1.5mm |
| Durability | 100 times | |
| Overvoltage category | 4 | |
| Pollution grade | 3 | |
| Ambient temperature | -25 to 60 C | |
| Temperature increase at power contact | Max. 45 C | |
| Allowable temperature at power contact | Max. 105 C | |

Receptacle

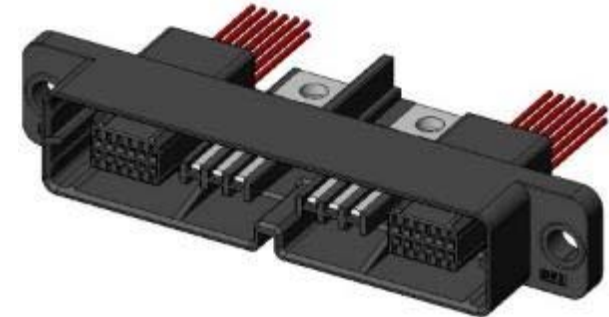

Plug



DW3 Application Example



Technology to Inspire Innovation

Receptacle

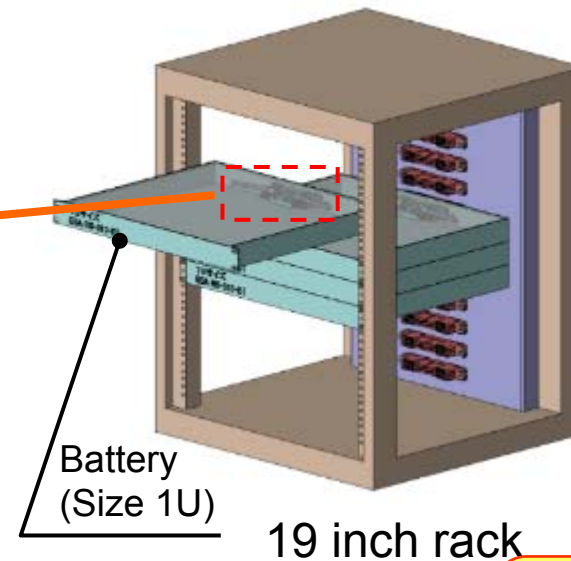
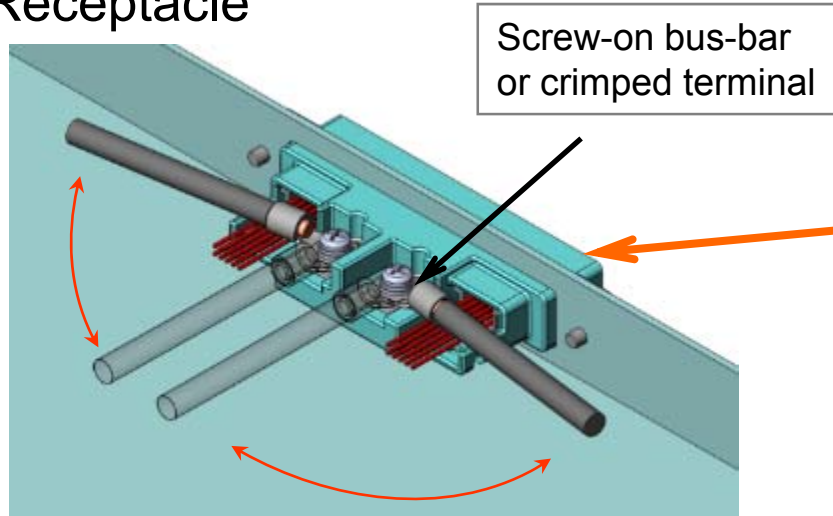

Plug

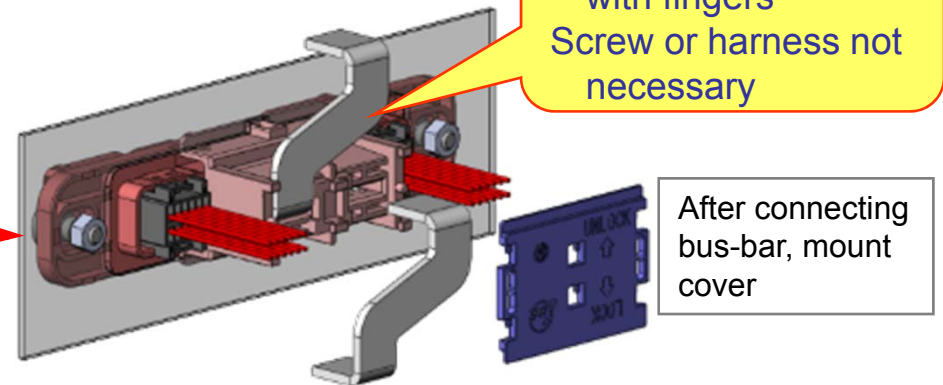
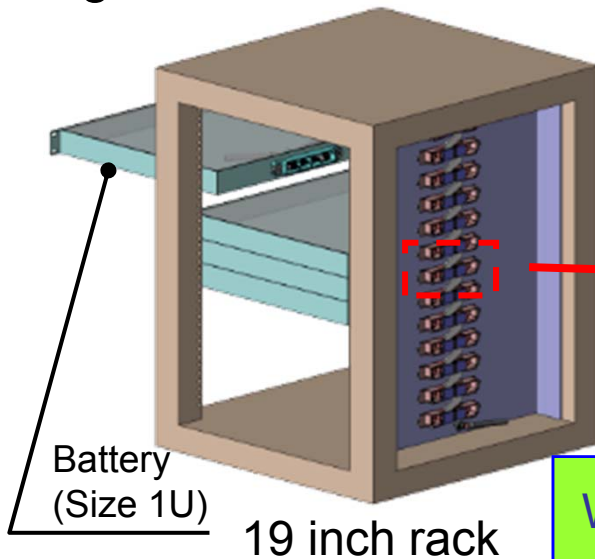

Workability made easy by direct connect to bus-bar (plug)

DW3 Connector Parts



Technology to Inspire Innovation

Contacts packaged in reels

Receptacle

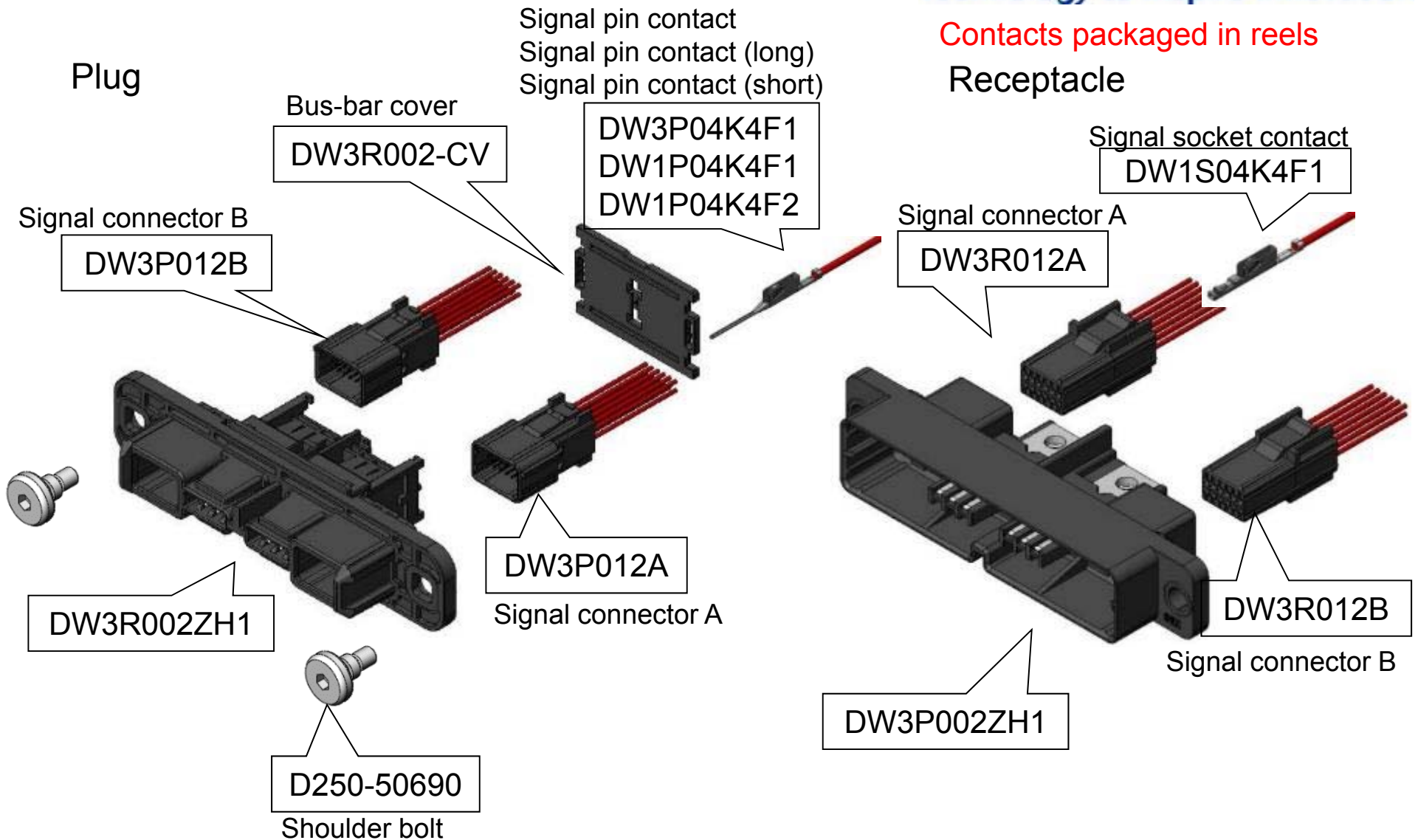

Features

- **100A current**
- **Electric shock prevention**
 - For safety, fingers cannot touch contact
- **Keyed to prevent mis-mating**
 - Reduce the risk of incorrect wiring
- **Easy connection and unplug**
 - Reduction of time needed for maintenance
- **Surface finishing**
 - Possible to change electrode plating
- **UL-approved flame retardant**

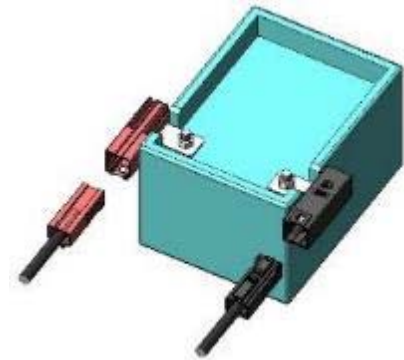

DW4 Application Example



Technology to Inspire Innovation

DW4 usage model

- 1) Connect between battery modules
- 2) Output of storage units

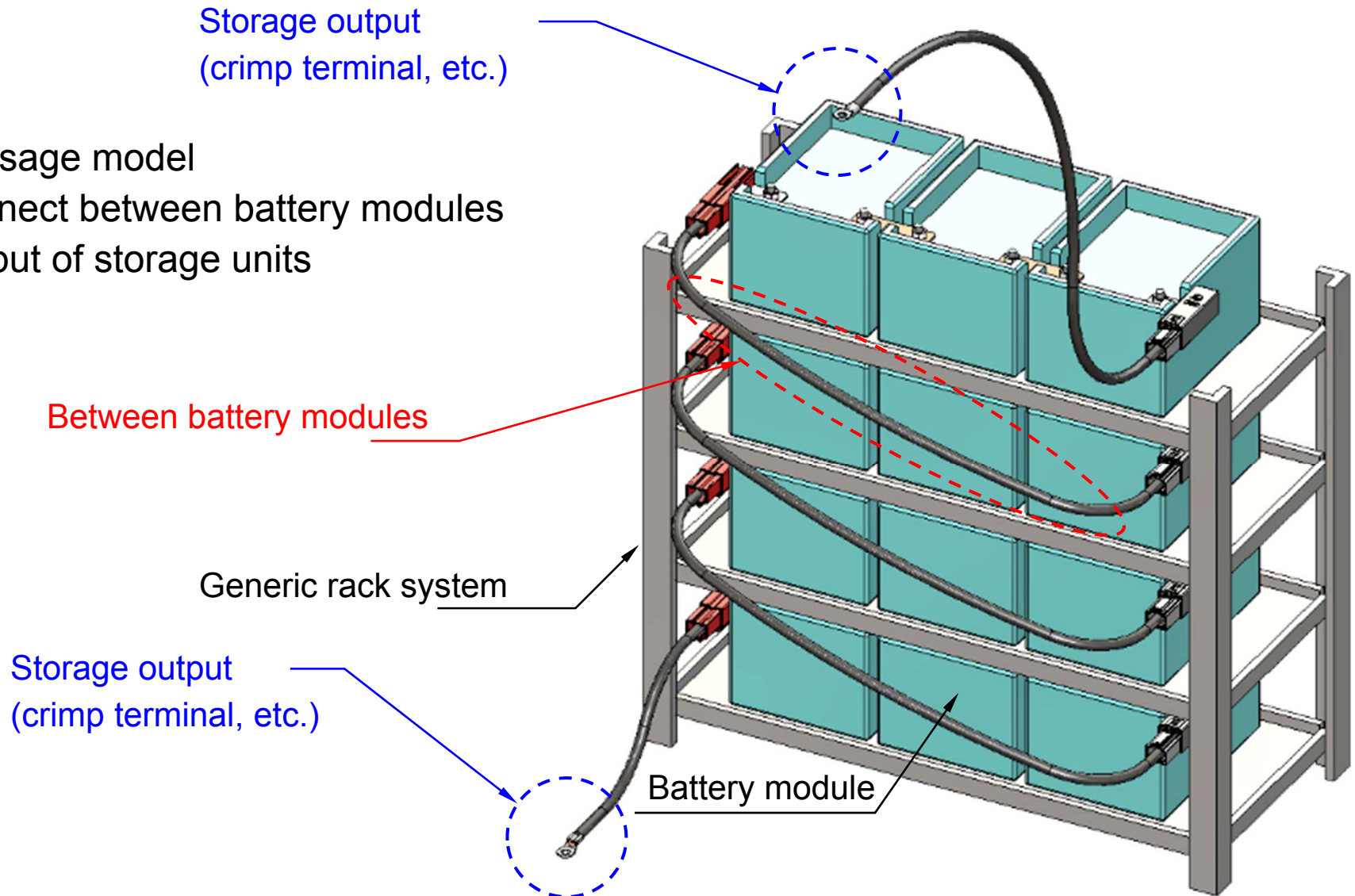

DW4 Connector Mounting



Technology to Inspire Innovation

Attachment to battery electrodes

-Plate and electrode secured by M8 screw.

Positioning by three insulator bosses

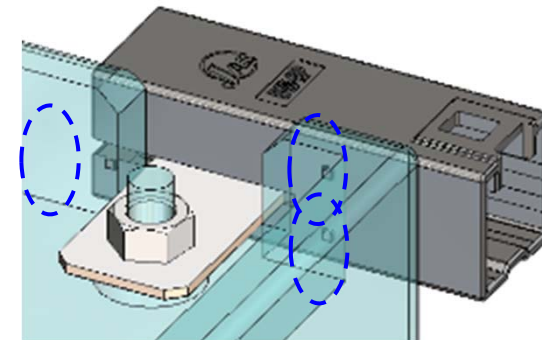

Positioning

Side bus-bar mating also possible

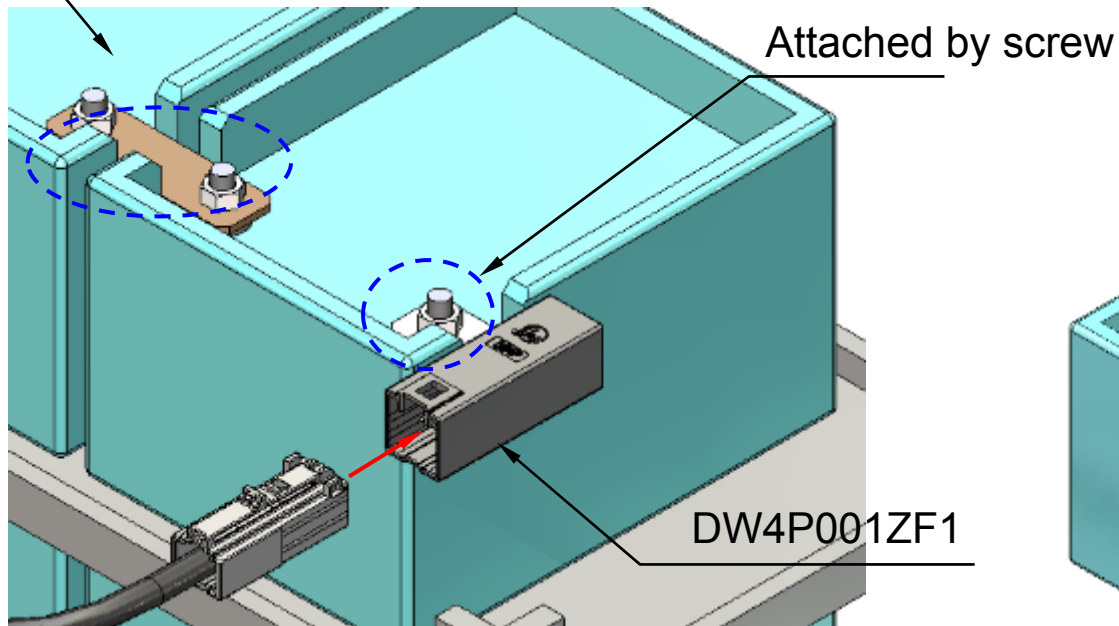

Attached by screw

DW4P001ZF1

Also possible to mount upside-down
Can be mounted to both sides of module

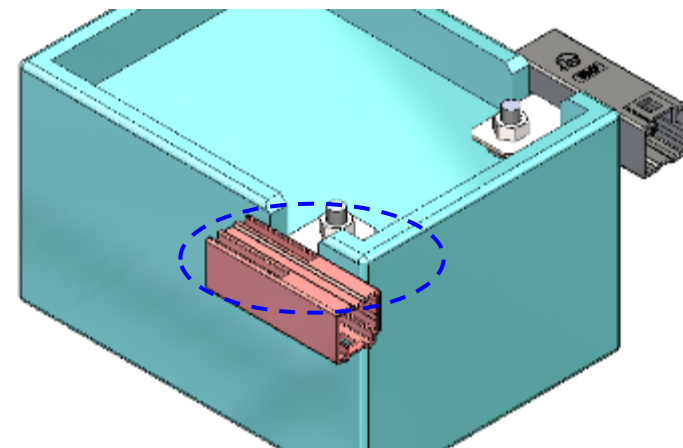

Mount on battery module (1)

Mount on battery module (2)

DW4 Part Numbers



Technology to Inspire Innovation

Battery side connector (red)

DW4P001ZF2

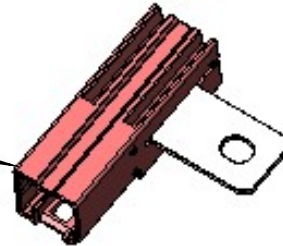

Battery side connector (black)

DW4P001ZF1

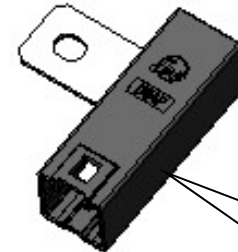

Harness

DW4R001W0012880

